



radinn®

**Creating waves
since 2013**

Passion

I'm often asked 'How did you come up with the idea of creating this board?'. The short answer is that it wasn't really my idea; in fact people have been trying to achieve this with varying results since the 1950s. But in spite of my predecessors' troubles my idea – or rather my strong belief – has always been that it must be possible to not only make cool and powerful jetboards but to also create something larger – a community of jetboarders! I even imagine a way of Life, as so many board sports have grown into and inspired before us.

Pedigree

At Radinn we've created jetboards since 2013. And ever since my first prototype I've seen the unbridled fascination and joy the Radinn board brings out in people wherever it has been showcased.

We have now completely reinvented our own earlier innovation and launched the World's first commercially available electric jetboard – a jetboard that is not only powerful but safe, intelligent and extremely fun. The jetboard.

Legacy

Our mission is to make jetboarding available to anyone who hungers for action watersports – and to keep striving for faster, more radical, and safer ways to catch that thrilling 'Radinn wave'.

Alexander Lind,
Founder of Radinn

A stylized, handwritten signature in black ink, likely belonging to Alexander Lind. The signature is fluid and cursive, with a large, sweeping loop at the bottom.

Congratulations on your new Radinn jetboard!

You are now the owner of the world's most advanced electric powered jetboard. The jetboard is a powerful personal watercraft designed to push the boundaries of the extreme sports industry. We at Radinn are extremely proud of what we have accomplished with the Radinn jetboard and we hope that you will soon be out in the water discovering for yourself the incredible joy of shredding completely independent of any boats, winds or waves.

However, before you head out into the water we ask that you take some time to read this manual thoroughly. As we all know, with great power comes great responsibility. If not operated correctly, the jetboard could cause harm to yourself, people nearby and/or the surrounding environment. This manual is prepared to give you all the information you need to enjoy the jetboard in a fun and safe manner.

Last but not least, the Radinn team would like to wish you countless hours of joyous, thrilling adventures with your new jetboard.

All the best,
The Radinn Team

Connected control

Keep your board happy and working at maximum capacity for a long long time. Data is continuously transferred from your board to the app and you'll be notified if something is out of the ordinary. At the same time the data will automatically be analysed so that we can keep you informed on potential service needs.

You can also check battery levels, run diagnostics, read the Radinn manual and much more.

Set your own limits - or eliminate them all together. Power up or down your Radinn-board via the app depending on how or where you want to ride. Or who's gonna ride it. Make sure the magnetic key isn't connected if you want to use the app.

Download the Radinn app
from your app store



CE

Radinn Product Manual

1 Overview

8 Product Overview

- The Jetboard
- The Remote

12 Standard delivery

- The products

2 Safety

14 Warnings & Safety

- Information & Disclaimer
- The Radinn jetboard
- The Radinn Power Pack
- The Radinn Charger

22 Safety Information

- Concerning the User
- Concerning the Radinn jetboard
- Concerning Operating the Radinn jetboard
- Concerning the Radinn Power Pack
- Concerning the Radinn Charger
- Proper Use of the jetboard

3 Setting up

42 Board preparations

- Charging the Power Packs
- Charging the Hand Control
- Board assembly
- Pair board with Hand Control
- Remote Control Technical Specifications
- Remote Control Indicator Table
- Fasten and Secure Hand Control and Magnetic Key
- Board assembly – Fins
- Launch the jetboard

4 Usage & Care

60 General usage

- Start sitting on knees
- Standing up
- Turning
- Common mistakes

68 Maintenance

- Power Pack maintenance
- Board care

75 Disposal

- Disposal of the Radinn Power Pack and all the other parts of the jetboard

Product overview

Top view

- 1 Battery compartment
- 2 Magnetic key holder
- 3 Handle

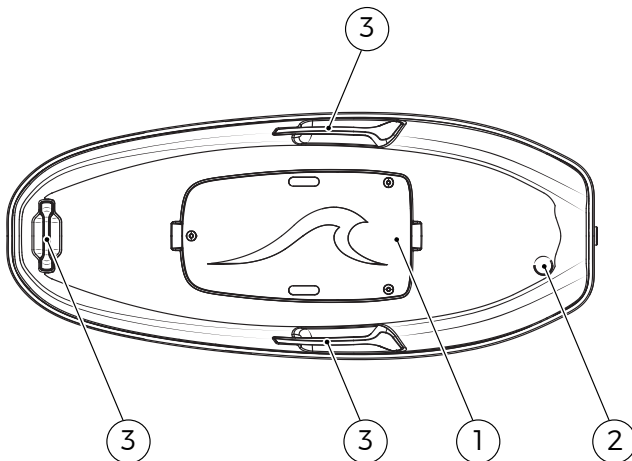

Side view

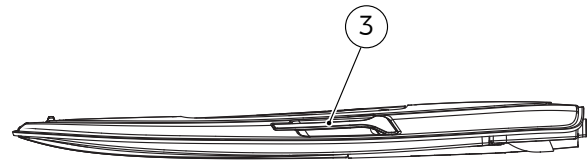

Bottom view

- 4 Jet intake
- 5 Jet outlet

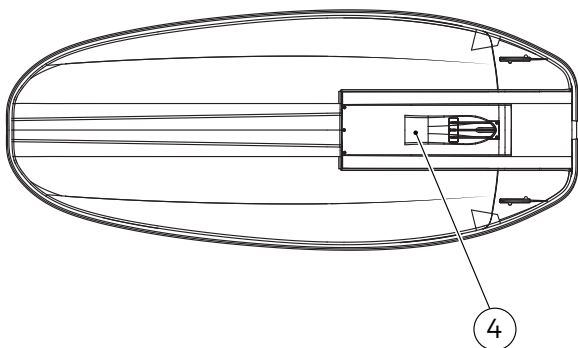

Back view

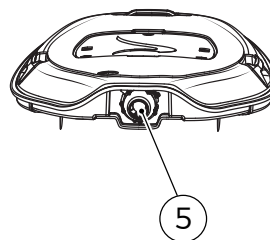

PRODUCT OVERVIEW

Product overview

Remote - front

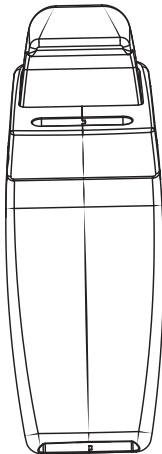

Remote - left side

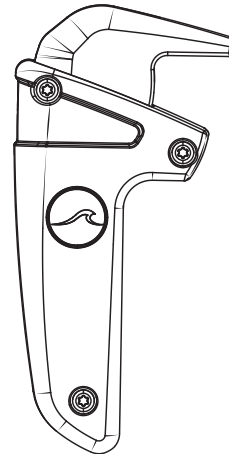

Remote - right side

- 1 Throttle lever
- 2 LEDs

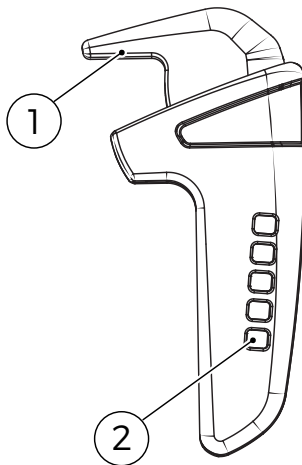

Remote - back

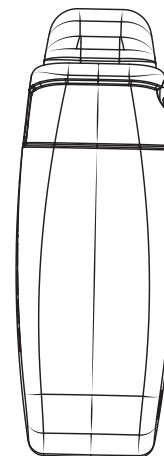

Product overview

Standard delivery

The following components are included in the standard delivery:

1. Radinn® jetboard with
2. Radinn® Power Pack
3. Radinn® board bag
4. Radinn® Charger
5. Radinn® remote control with charger
6. Radinn® magnetic key with leash
7. Radinn® fins, optional accessory
8. Radinn® manual



The Radinn Power Pack and the Radinn Charger are delivered in two separate packages.



The Radinn Power Pack is delivered in a partially charged state. We recommend that you charge it immediately at delivery (within 10 days).

STANDARD DELIVERY

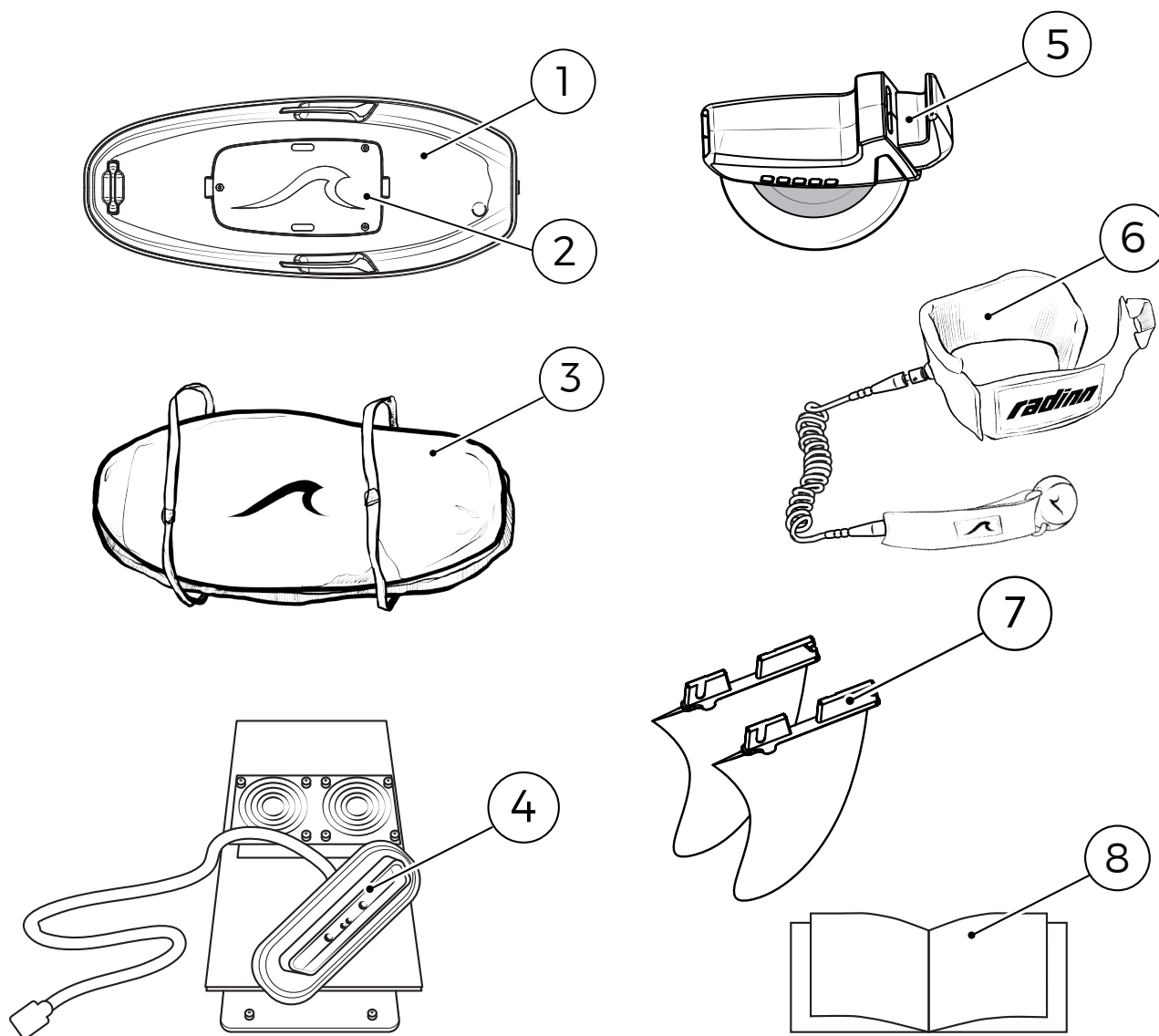

WARNINGS & SAFETY

Important information



WARNING! If you suspect that the battery connector has been in contact with water, or if the battery in any way looks damaged, do not connect the battery to the board! Please contact Radinn immediately for more information.



radinn.com/pages/contact-us

Before you jump into the water and experience your very first ride on the jetboard – we urge you to carefully read through this Manual. It is of uttermost importance that you understand and follow the operation and safety instructions for this very powerful product.

The Jetboard is safe to operate, in line with the latest industry standards. However, the jetboard is also a powerful electric vehicle and can cause serious injury and/or death to you and/or others if operated in misconduct. We therefore insist that you, in detail, read the safety information and the operation instructions.

The following symbols are used in this Manual to bring attention to information of great importance:



Caution! Danger of injury and/or death. This symbol indicates that operating the jetboard involves risk of injuries and/or death to the operator and/or other people.



Stop! If not implemented correctly it may cause damage to your jetboard and/or other/s property.



Information! Instructions for operation, maintenance, service and/or other guidelines.

Disclaimer

Radinn AB strives to continuously re-innovate and keep the jetboard updated in line with the latest in technological breakthrough, with regards to technology, components, software, electronics as well as, but not limited to, design, materials and composites. Therefore, Radinn AB reserves the right to change, remove, modify or in any other way alter the above characteristics as described in this Manual at any time without prior notice. Characteristics and functions described and illustrated in this Manual may therefore vary, differ or be incorrect. Radinn AB does not take any responsibility, to the extent prohibited by law, for any loss of business profits, damage, injury and/or death arising directly or indirectly from use of, or inability to use of, the information, illustrations and/or instructions in this Manual. Even though Radinn AB strives to provide as correct and up-to-date information, illustrations and/or instructions as possible - after the best of our knowledge and capacity - there are risks involved in the use of the jetboard. Radinn AB reserves therefore also the right to change, alter, remove or add information, instructions and/or illustrations in this Manual at any time without prior notice.

The Radinn jetboard is a highly qualitative product, engineered with state-of-the-art technology, composites and showcase the cutting-edge of professionally hand-crafted

electric vehicles. Nevertheless, using the jetboard in an unintended fashion, irresponsibly, or even by chance, may cause injury to, or death of, the operator and/or other persons. Also, other property of the operator or other people may be destroyed and/or damaged. Radinn AB therefore, to the extent prohibited by law, does not take any responsibility in injuries, death, loss of profit, damage or destruction by any property, natural environments, as a direct or indirect result of operating the jetboard. The jetboard, as any electric vehicle, shall be used responsibly, with respect and in line with the safety information and operation instructions.

Keep this Manual in a safe and easily accessible place for reference whenever needed.

You can also log into www.radinn.com to reach the information online - with reference videos, illustrations and updated information and instructions. You can also communicate with us by e-mail, phone, through our partner retailers, and/or through social media.

© Radinn is a registered trademark, all rights reserved.

Warnings and Special Safety Information on the Radinn jetboard

- **CAREFULLY** read the manual before handling, preparing, charging and operating your jetboard!
- Suitable **ONLY** for good swimmers aged 16 years or older!
- **NEVER** disconnect/connect the battery when the product is located in water.
- **ALWAYS** disconnect the battery during transport and/or when not intending to operate the jetboard.
- **ALWAYS** put on the protective connector-cover when the battery is disconnected from the jetboard.
- Do **NOT** connect the battery if the jetboard is exposed to water – for example, if on water, if it is raining outside, or if water is inside!
- **ALWAYS** wear a coast-guard approved life-jacket and helmet when operating the jetboard in water!
- **ALWAYS** maintain distance and low speed when close to people or objects (minimum 20 meters with slow speed)!
- **ALWAYS** wear tight-fitting swim-wear and/or a tight-fitting wet-suit!
- **ALWAYS** wear bathing cap and/or hair net if hair is shoulder length!
- **ALWAYS** observe the battery state through the wireless remote and return to shore with good margins of remaining battery power.
- **ALWAYS** follow local laws and regulations!
- **ONLY** use in sheltered waters with life-guard and rescue boat near and stand-by.

- Do **NOT** put body parts and/or other objects in open holes such as jet-propulsion intake or exhaust. Rotating parts!
- Do **NOT** use in environments with strong currents, heavy swells, bad visibility and/or floating objects in water!
- Do **NOT** use in environments occupied by swimmers and divers!
- Do **NOT** store in direct sunlight and/or closed vehicle!
- The jetboard is **NOT** intended for using as swimming aid!



WARNING:

Always operate the jetboard responsibly, with caution and in accordance with our safety information and operation instructions. Do **NOT** operate the jetboard if the board or any of its parts, components or accessories are damaged – for example, if cracked, leaking, punctured, bent, distorted or malfunctioning in any way. Do **NOT** use if the jetboard has been disassembled and/or reassembled by anyone other than a Radinn authorized technician. Do **NOT** connect the battery in or close to water. Do **NOT** expose the jetboard, the battery or the charger to heat (max. 40 °C/104 °F) – caused for example by open fire, direct sunlight, or storage in a vehicle or a very warm enclosure. If overheated the battery may cause high pressure flaming gas, causing explosion and fire, resulting in severe injury or death.

Warnings and Special Safety Information on the Radinn Power Pack

- **CAREFULLY** read the manual before handling, preparing, charging and operating your jetboard and Radinn Power Pack!
- Do **NOT** heat beyond 40 °C/104 °F, or below 10 °C/50 °F.
- Do **NOT** store in sunlight, close to open fire, in a motor vehicle or small and warm enclosure!
- Do **NOT** short circuit!
- Do **NOT** break open or disassemble!
- Do **NOT** throw, drop, puncture, slide or in any other way damage your Power Pack! **HANDLE WITH CARE!**
- Do **NOT** submerge in water or other liquid!
- **ONLY** charge with the official Radinn Charger that is delivered with the product!
- **ALWAYS** disconnect the battery from the charger when you are not actively charging the battery.
- **ALWAYS** handle the Radinn Power Pack carefully within a safe distance from water!
- **ALWAYS** put on the protective connector-cover when the battery is disconnected from the jetboard.
- **ALWAYS** disconnect the battery during transport and/or when not intending to operate the jetboard.
- **ONLY** connect/disconnect the battery in dry locations unexposed to water or liquid!
- **ONLY** charge in dry areas with safe distance from water or liquid!
- **CAREFULLY** observe instructions of charging, discharging, storage and transportation!



WARNING:

Always use the jetboard and the Radinn Power Pack responsibly, with caution and in accordance with our safety information and operation instructions. Do **NOT** operate the jetboard or use the Radinn Power Pack if the board or any of its parts, components or accessories are damaged – for example, if cracked, leaking, punctured, bent, distorted or malfunctioning in any way. Do **NOT** use if the jetboard has been disassembled and/or reassembled by anyone other than a Radinn authorized technician. Do **NOT** connect the battery in or close to water. Do **NOT** expose the jetboard, the battery or the charger to heat (max. 40 °C/104 °F) – caused for example by open fire, direct sunlight, or storage in a vehicle or a very warm enclosure. If overheated, the battery may cause high pressure flaming gas, causing explosion and fire, resulting in severe injury or death.

Warnings and Special Safety Information on the Radinn Charger

- Carefully read the manual before handling, preparing, charging and operating your jet-board, the Power Pack and the Radinn Charger!
- Do **NOT** expose to direct sunlight!
- **ALWAYS** disconnect the battery when not actively charging it.
- Do **NOT** open, disassemble or re-assemble!
- Use only when connectors on Radinn Power Pack and Radinn Charger are clean and dry!
- Never use if cables and/or plugs are damaged!
- Charge only in dry, cool and well ventilated locations!
- Do not cover! Ensure free air circulation!
- The Radinn Charger may heat up during charging. Ensure that it has good time to cool down before handling!
- Do **NOT** charge the battery in or close to water!
- **ALWAYS** handle the charger with care.



WARNING:

Always operate the Radinn Power Pack and Radinn Charger responsibly, with caution and in accordance with our safety information and operation instructions. Do **NOT** use the Radinn Power Pack and Radinn Charger if any of its parts, components or accessories are damaged – for example, if cracked, leaking, punctured, bent, distorted or malfunctioning in any way. Do **NOT** use if the charger has been disassembled and/or reassembled by anyone other than a Radinn authorized technician. Do **NOT** cover the charger. Do **NOT** connect the battery and charger in or close to water. Do **NOT** expose

the jetboard, the battery or the charger to heat (max. 40 °C/104 °F) - caused for example by open fire, direct sunlight, or storage in a vehicle or a very warm enclosure. If overheated the battery may cause high pressure flaming gas, causing explosion and fire, resulting in severe injury or death. Do **NOT** connect the charger if there is any visual or suspected damage to connectors, chords, cables, electronics or hardware. The Radinn Charger and Radinn Power Pack can result in severe injury or death if used irresponsibly or outside the operating instructions and safety information.

General Safety Information Concerning the User

- Use of the jetboard is restricted to experienced swimmers aged 16 or older.
- The jetboard, like any other motorized vehicle, must be used with great respect and caution. It is a vehicle, not a toy!
- Individuals with pacemakers are restricted from using the jetboard. The electric motor and cables carrying high-currents create a strong magnetic field that can severely damage the pacemaker and consequently result in death.
- Pregnant women are restricted from using the jetboard. Falling off can cause severe injury to the abdomen.
- Never use the jetboard while under the influence of alcohol, medication or drugs. Your ability to react quickly, your strength and endurance may be considerably inhibited in an emergency situation.
- Never use the jetboard unless feeling completely healthy. Your ability to react quickly, your strength and endurance may be considerably inhibited even when only having a cold.
- Only wear tight-fitting clothing without loose-hanging straps or items. If your hair is shoulder length or longer, always wear a swimming cap or hairnet. The jetboard's jet-propulsion-system is very powerful and creates a strong suction. The jet is equipped with bars to protect as large an area as possible without affecting the jetboard's performance. Yet, there is always a risk that long-hanging clothing, straps, hair or similar can get sucked in. Should this occur there is risk of injury.

- Always wear a coast-guard approved life-jacket and helmet whenever out riding the jetboard. Be aware of your distance to shore and make sure that you are in short enough distance to shore that you can swim in the case of an emergency. Be aware of currents, changing weather and waves.
- Never use the jetboard alone and only if there are individuals with a proper rescue watercraft on stand-by.
- Make sure that your wireless remote and Radinn Power Pack is properly charged before heading out. Be attentive so that you always have enough battery power to reach back to shore.
- **ALWAYS** wear your magnetic safety leash. If the magnetic safety leash is not properly attached to the rider, the jetboard risks injuring other people and/or property.
- Never connect/disconnect the Power Pack when the jetboard is in water. Always connect/disconnect the Power Pack in a dry location without risk of the product falling in the water. If water enters the connectors it can result in a short circuit that can damage the product and in the worst case cause severe injury and/or death. Always put on the protective connector-cover when the battery is not connected to the jetboard, both on the board and on the battery to ensure that it is clean, dry and safely kept from other objects that can damage the connectors.

General Safety Information Concerning the Radinn jetboard

- Always make sure to prepare the jetboard outside of the water. It is important that the Radinn Power Pack is **ONLY** connected in a dry area. If connected in or near water there is always an inherent risk of short circuits which can result in severe damage, injury or death.
- After riding, always tilt the jetboard to allow for water to drain properly. Make sure no water enters the board's connector while draining.
- Make sure not to reach into the jet and remove sea grass or similar in the jet with your hands. There is a high-speed rotating impeller inside the jet that can cause severe injury. Make sure that there are no other people, such as kids, nearby that can reach into the jet.
- Be careful to ride where there is no or little chance of sea grass or similar debris to get into the system. If this would occur, **NEVER** try to remove this while the jetboard is still in water and the magnetic safety leash is attached to the board.
- If there is any dirt, sand, rope, stone, sea grass or foreign objects in the jet channel or the jet, do **NOT** ride the jetboard. If the procedure of removing the debris is simple, make sure that the magnetic safety leash is removed and **NEVER** use your hands or body parts to remove it. If it is a complex procedure, contact your closest authorized Radinn representative or retailer for servicing.
- Never leave the jetboard unattended so that kids or other inexperienced people can't unintentionally or intentionally start it, use it and risk injury of themselves or others. Always bring your magnetic safety leash with you to prevent accidents.

- The jetboard is a light-weight product relative to its power, autonomy and speed. Yet, dropping the jetboard on objects or individuals can result in damage and/or injury of the jetboard and/or other objects and individuals.
- Always place the jetboard in shade or out of direct sunlight. Remember that the jetboard holds internal batteries that risk getting hot. If the batteries are exposed to severe heat, the jetboard and its accessories can get damaged. Even worse, if stored too long in direct sunlight the Radinn Power Pack can discharge flaming gases and result in explosions and fire, resulting in injury or death.
- Never leave your jetboard unattended in the water. If you leave it for a short while, remember to have oversight so that the jetboard cannot become unattached, injure others, be used by others or be in the way of people, boats or objects.
- Remember to **NEVER** detach or remove the battery while the device is in the water. Always take precautions to prevent the high-current connecting plates on the battery and the jetboard from coming into direct contact with the water. If this occurs, a short circuit may result, causing irreparable damage to the jetboard's electronic system.
- Water, especially salt water, is highly conductive of electricity. As a result, a short circuit can result in the battery discharging flaming gases that can cause explosion and fire, resulting in injury or death.

General Safety Information Concerning the Radinn jetboard – continued

- Before connecting the Radinn Power Pack to the Radinn Charger, make sure that the charging connector and battery connector are clean and dry. Wet and/or dirty connections with the battery and charger may cause a short circuit to occur - which can result in damaged battery electronics, fire and explosions, resulting in severe injury or death.
- Before operating the jetboard, make sure that the battery is securely connected to the board.
- **NEVER** remove the deck pad and/or try to enter the Jet compartment. Opening the Jet compartment and altering the internal components can damage the sensors, motors, electronics and/or software - which can result in the safety functions and systems to fail and can potentially cause permanent damage causing severe injury or death.
- Never stick objects into holes, openings, connectors or other electronics, hardware or software. This may damage the components, parts or board.
- Never try to service or repair anything other than what is clearly specified. Service may only be carried out by an authorized technician in order to ensure safety of yourself, your environment and the jetboard. Due to its modular design it is unlikely that the entire jetboard will have to be shipped to one of our facilities for service or repair. It is much more likely that an authorized Radinn retailer, dealer or distributor can replace any damaged/broken component so that you can be out in the water again in no time. Please do not try to repair, service or maintain anything yourself – for your own and your environment's safety.

SAFETY INFORMATION

- Never alter or modify any part of the jetboard. Doing so may result in severe injury or death, as well as damage or destruction to your and others property.
- If you detect any damage to your jetboard, especially to the Power Pack, charger, charging connectors, seals or closing mechanism, immediately stop operating the device and contact the manufacturer and/or your authorized Radinn dealer.

General Safety Information Concerning Operating the Radinn jetboard

- Operating the jetboard is always at your own risk. Operators do not afford any special rights. It is a powerful vehicle that must be operated with respect, care and precaution according to the safety instructions and the operating manual – no matter the experience level.
- Only use the jetboard in sheltered waters that is accompanied by at least one other person equipped with a powered watercraft suited for rescue and under constant supervision of this individual. You as a rider always need to have someone who can provide you with immediate assistance in case of emergency – no matter the level of experience.
- Never operate the jetboard in strong currents, strong winds (4 on the Beaufort Scale), bad weather, narrow water ways (50 meters wider or less) or other areas where risks are imminent. By doing so, you put yourself and others at risk and in danger of severe injury or death.
- Never use the jetboard in a thunderstorm. Get out of the water as quickly as possible if you catch yourself in a weather situation that might turn into a thunderstorm. Not doing so may cause serious injury or death. Always be prepared for a sudden change in weather and maintain good oversight of the weather forecast before you start riding. Pay close attention to local weather conditions and swimming recommendations and/or restrictions.
- Never use the jetboard in heavy swells, measuring maximum 0,3 min height and occasional waves of 0,5 m. The jetboard can cause severe injury to you and others. You may be separated from the jetboard and it can/may be thrown with great force onto you, others or objects – especially when in the surf.

SAFETY INFORMATION

- You can change the maximum speed and different acceleration curves in the iOS Radinn app. This can minimize risks of injuring the jetboard, objects, yourself and others.
- To brake, just release the thrust of the Radinn wireless remote. The motor will stop spinning and the force of the water reaching the non-spinning impeller will force the jetboard into a halt. Remember to prepare for breaking and that it can take up to 10-15 meters to come to a complete stop if running in maximum speed. It might even be longer if falling off the jetboard. Therefore, always be careful not to ride directly in line towards an object or individual. It can damage the jetboard, the object and/or yourself and other individuals. Be sure to let go of the thrust on the wireless remote gradually, so that you can reach your destination safely.
- If the jetboard comes to a stop due to the rider falling off the board, it can continue for more than 30 meters in rare occasions. Be careful so that you never ride in shallow waters, close to other objects, property, swimmers, people or anything that can damage yourself, others, your property or others as well as the natural habitat you are riding in. Be careful and only go in full speed/throttle when you have a clear view of at least 500 meters ahead in good weather conditions.
- Do not use the jetboard in areas occupied by swimmers, divers, docks, harbors, or where others property is at risk. If doing so is absolutely necessary to get out in a riding area, make sure you lay on your stomach and ride at maximum 20% of the jetboard 's capacity (maximum 5 knots).

General Safety Information Concerning Operating the Radinn jetboard – continued

- Always avoid routes that are occupied by watercrafts, water sport products or other jetboard riders. The jetboard is an extreme sports product that can be more difficult to control than a normal watercraft. Therefore, always be sure to go in a safe and slow manner when passing, meeting or riding away from other watercrafts and/or water sport articles, as well as objects and swimmers. Other water crafts may be approaching fast and appear suddenly. Keep an eye on your environment and what is happening farther up ahead. Beware of potential collisions!
- The jetboard is not equipped with lights and is therefore unsuitable to operate during night, in early mornings, or late evenings. Never operate the craft after sunset or before sunrise. Doing so can put yourself and others in danger and collisions with other watercrafts, obstacles or individuals are imminent.
- Do not operate the jetboard in water that is less than 1,5 meters deep. Doing so can result in severe injury to yourself, others and your jetboard – as a result of hitting underwater objects. Stay away from rocky bottoms, coral reefs and other dangerous areas where a fall can result in severe injury. Never attempt to steer the jetboard directly up to shore. You may fall onto land and injure yourself and others severely. Be very careful not to ride the jetboard too fast when getting close (30 meters) to shore.
- The operating time of the jetboard is limited to the battery capacity. Therefore, you must always keep an eye on your battery level indicator as communicated on your Radinn wireless remote. Always return to shore with some margin. Never attempt to finish the entire battery. It can be dangerous and is unhealthy for the Radinn Power Pack.

- When the Radinn Power Pack is discharged to approximately one third of its charge state, the maximum power drops incrementally (90%, 80%, 70% etc) to prolong the battery cells health and increase charging cycles. When the battery indicator on the wireless remote is at its last stage, the jetboard goes into emergency mode and has approximately 5 minutes left before the board comes to a complete stop. Please always make sure to have enough remaining battery to get safely to shore or an accompanying boat. The jetboard is not designed to paddle on, which makes it very difficult and strenuous to paddle ashore with.
- In most instances, the general personal liability insurance of any rider does not cover property damage caused by the direct or indirect use of the jetboard. Before using the jetboard, please make sure to contact your

insurance agent and research your insurance policy for coverage cases involving damage, injury and even death. It can be overwhelmingly expensive if you damage someone else's property. We urge you to think twice before riding anywhere with a possibility of damaging anyone's property.

General Safety Information Concerning the Radinn Power Pack

- Never expose the jetboard or the Radinn Power Pack to high temperatures (max. 40 °C/104 °F) – caused for example by: open fire, direct sunlight, or storage in a very warm and small enclosure such as a motor vehicle. If exposed to excessive heat as mentioned above, the cells can discharge flaming gases and cause explosion or fire resulting in severe injury or death to you and others.
- International regulations and laws on lithium-ion batteries may cause inconveniences, difficulties or impossibilities of transporting the Radinn Power Pack. Commercial airlines prohibit the transportation of lithium-ion batteries. Please contact your local carrier for information with regards to shipments and transportation of the Radinn Power Pack.
- For use under normal conditions the cells contained within the Radinn Power Pack are encased and protected to ensure safe storage in any position. **PLEASE NOTE:** The connectors can still be exposed to water and can if wet result in a short-circuit damaging your Power Pack. **NEVER** connect the Power Pack to the jetboard if there is reason to suspect that water has entered the connectors. **ALWAYS** put on your protective connector-cover on the Power Pack **AND** the jetboard as soon as they are disconnected.
- If you suspect that a short-circuit have occurred:
1. Immediately disconnect the battery from the jetboard. **2.** Contact Radinn or an authorized dealer if you have reason to believe a short-circuit have occurred. **DO NOT** repeatedly re-connect the battery to the board if you have reason to believe that you have had a short-circuit or that the battery in any other way may have been damaged.
- Only use chargers supplied by Radinn to charge

the Power Pack. Chargers that are not supplied by Radinn are not equipped with the electronics and software to safely and reliably charge and balance the cells. Therefore, charging with unauthorized chargers may result in destruction and in worst case severe injury or death.

- Beware of the strong line currents that are present when charging the Power Pack, in particular on the speed charger. Never use the charger if the main cable is damaged. Doing so can cause the cable to catch fire and may lead to electric shock resulting in severe injury or death.
- Never open the accumulator box. Never attempt to alter or modify the Power Pack in any way. Doing so may cause flaming gases to be discharged through the accumulator cells safety valve, causing serious injury and/or death.
- Repairs and service work on the Radinn Power

Pack is restricted to Radinn and its authorized partners.

- Never leave the Power Pack connected in the jetboard or the charger when not actively intending to charge or operate it . When the Power Pack recognizes data connection, it starts sending out a 12V data current. If left long enough, the Radinn Power Pack can unnaturally and completely discharge resulting in permanently damaging the batteries internal cells.
- Ensure that there are no water or dried salt deposits on the contacts of the connector sockets of the jetboard, the Power Pack or the charger when connecting (see Chapter "jetboard Maintenance"). Salt deposits can inhibit the flow of electricity during charging and cause electrical contacts to overheat, resulting in irreparable damage to the contacts or even fire.

General Safety Information Concerning the Radinn Power Pack – continued

- Always charge the Power Pack in the shade indoors and in a place that is dry, cool and ventilated. Ensure the Power Pack or the charger is not covered by any foreign objects or clothing. If the Power Pack is hot, let it cool down before charging it. Ensure that air can circulate freely.
- Careful! The charger and the Power Pack can get hot when charging. Please allow the Power Pack and charger to cool down before handling them.
- Some countries may not be equipped with a ground wire connection or, if they are, it may provide only insufficient protection. If this is the case, you can feel the presence of a leaking current (sometimes more, sometimes less) when you touch the charger and/or the charging plug. Especially if you are wet and barefoot. For this reason, you should always connect the Power Pack to the charger before turning on the charger. Never touch them during charging.
- Before storing the Power Pack, please ensure reading chapter “jetboard Maintenance”. It is very important that you carefully follow the storing instructions, especially for long-term storage (e.g. over the Winter). The Power Pack should always be stored in a cool (15-28 °C/59-82 °F), dry, and well-ventilated area.
- When transporting the Power Pack, always carefully observe the applicable safety regulations and the specific regulations of the carrier. Be aware that rules concerning the shipping of lithium-ion batteries are changed from time to time and can differ among different countries and carriers.

SAFETY INFORMATION

- **NEVER** discard the Radinn Power Pack among normal household waste or recyclables or in fire or water. Always contact your local dealer or Radinn directly on how to discard your Power Pack.

General Safety Information Concerning the Radinn Charger

In addition to the special safety information on the Radinn Charger, be sure to properly read and understand the following safety information:

- Never use the Radinn Charger if the connector, wires or body are torn, broken, damaged or destroyed. If suspecting that the charger, cables and/or connectors are broken, damaged or destroyed immediately contact Radinn or your local authorized Radinn dealer.
- Repairs and service work on the Radinn Charger is restricted to Radinn and its authorized dealers solely.
- Never leave the charger connected to the Power Pack when not actively charging it. When the connectors are connected there is always a current on. This can result in the Radinn Power Pack becoming completely discharged and de-

stroy the cells. Additionally, it can cause children, animals or other people to accidentally touch the pins and get electrified causing severe injury and/or in worst case death.

- Never leave the Radinn Power Pack and charger when charging. **ALWAYS** be close by so that children, animals or other people cannot get accidentally injured when charging the Power Pack. In addition, the charger can get hot during charge and should therefore be kept in a dry and ventilated area.



Proper Use of the Radinn jetboard

Introduction

- The jetboard is a water sports vehicle driven by a high-power lithium-ion battery, a powerful electric motor and a jet-propulsion system that enables the user to ride across the water in high speed. The power is controlled via a wireless handheld remote in which the rider can choose the preferred acceleration and speed. All of the metal parts are of high-quality anodized aluminum and/or stainless steel, treated to resist corrosion and rust. The jetboard is suitable both for use in fresh water and salt water. The battery and jet compartment is water-proof. The jetboard's internal system is equipped with many smart functions and electrical as well as mechanical safety features that keeps the rider safe.
- However, if the safety information and operating instructions are not followed, and/or if the operator is acting under bad judgment, irresponsibly, mistreating the product, or in other ways acts opposite of common sense when handling a powerful vehicle – there is a risk that you will injure the jetboard or other property, as well as risking your own and other peoples' lives. Please respect that the jetboard is an electric sports vehicle used on water, it is **NOT** a toy and should be used with uttermost respect, precaution and always in line with the local regulations and laws.
- Remember that vehicles of any kind can malfunction and cause an emergency situation, therefore always have another person nearby with a watercraft that can be used for life-saving situations. Always follow the information that is described below with regards to proper use of the jetboard, as well as the chapters regarding "Warnings and Special Safety Information" and "General Safety Information" in this manual.

SAFETY INFORMATION

- Make sure to take your time to understand how the jetboard works before performing more difficult maneuvers such as riding at top speed and slide turning. Only attempt these maneuvers when you have complete control over the jetboard and a full understanding of how to turn by shifting weight/legs and how the board slides when falling. Limit your speed so that you are in complete control of the jetboard at all times. Always use the jetboard responsibly and show consideration to people, animals, coral reefs, plants and the environment.
- The jetboard has a maximum output of 12 kW/16 HP in standard settings. Some countries do not require a driving license for operating a watercraft at this power. Some countries, however, may have other regulations, age restrictions or laws. Carefully check to always follow your local regulations and laws prior to operating the jetboard. We urge all jetboard operators to inform themselves completely about the local regulations. Radinn does not assume any responsibility for unlawful operation of the jetboard in restricted areas. Additionally, Radinn does not assume any responsibility for obtaining such information for the user.
- The jetboard should only be used in sheltered waters. Sheltered waters are here defined as sheltered/protected coastal waters, small bays, small lakes, rivers and canals where conditions up to, and including, wind-force 4 and significant wave heights up to, and including, 0,3 meters may be experienced, with occasional waves of 0,5 maximum height. E.g. waves from passing vessels.
- It is always recommended to carry the jetboard by two people and as often as possible in the complimentary board bag with wheels. This is to minimize the risk of injury to the jetboard, yourself or your surroundings.

SAFETY INFORMATION

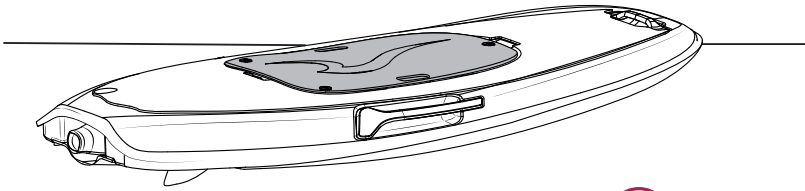

IMPORTANT:

When fins are installed you have to be careful when pulling your board onto land or onboard a boat. Under no circumstances should you put any weight on it while the fins rests on land.

- Never run the motor out of the water for longer than approximately 10 seconds. The motor is designed to be used in the water, and prolonged operation out of the water to test the jetboard and the remote can damage the bearings, coupling, motor and/or system. Additionally, the watercooling will not work if running the jetboard out of the water.
- Often the jetboard can be operated in areas where the use of combustion engine powered watercrafts cannot. Use of the jetboard is, however, never permitted in areas where electric watercrafts are prohibited due to: local laws, community regulations, nature conservation laws, or other provisions. If you are uncertain about local laws and regulations, make sure to inquire the local authorities.
- Users of the jetboard must be at least 16 years of age and good swimmers. People who cannot swim should never use the jetboard.
- Minors, 16 and older, may only operate the jetboard under the supervision and responsibility of an adult.
- Only let other people use the jetboard if they are over 16 years of age and have shown you adequate proof of such. The jetboard should never be used unless the operator has received full instructions on how it should be used and knows what to do in case of an emergency.



Charging the Power Packs

1

Connect the power cable to the power supply. Then connect the charging cable to the charger.

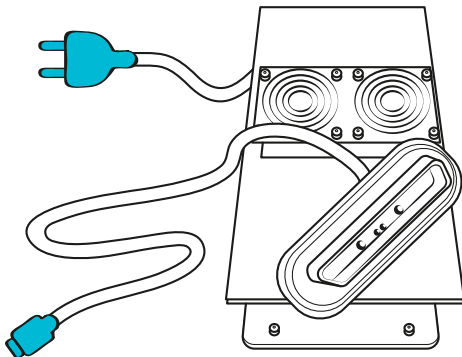

2

Connect the charging cable to the Power Pack. A clicking sound will indicate when the Power Pack is properly connected.

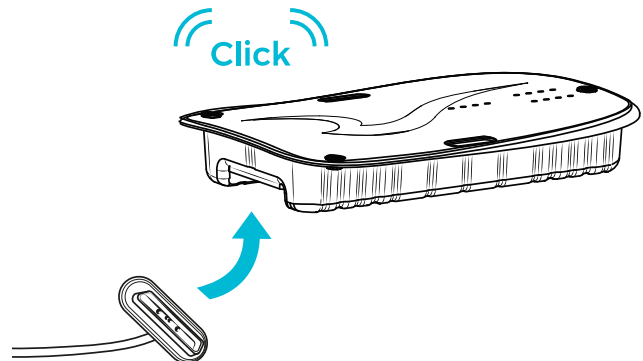

3

Charge the Power Pack until the LED2-light turns green.

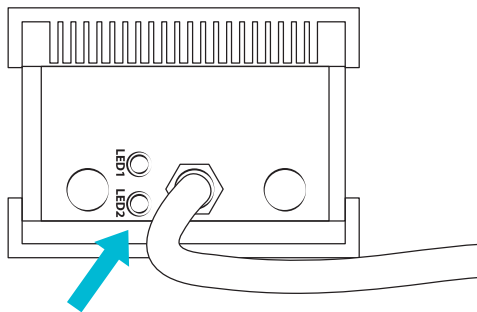

IMPORTANT:

Always fully charge the battery before using it.

Never fully discharge the Power Pack.

Read **Power Pack Maintenance** to extend the lifetime expectancy of your batteries.

Power Pack Battery Charger LED Indicator Table

Indication	Definition
LED 1: red LED 2: green	When connected to battery: The battery is fully charged. When not connected to battery: AC current switched on
LED 1: red LED 2: red	The battery is charging

BOARD PREPARATIONS



Charging the Hand Control

1

Connect the power cable to the power supply. Then put the throttle on the charger as shown in the image.

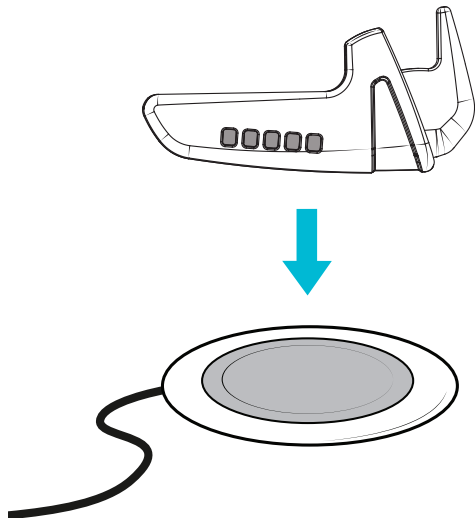

2

When the hand control is being charged one of the LEDs will start flashing.

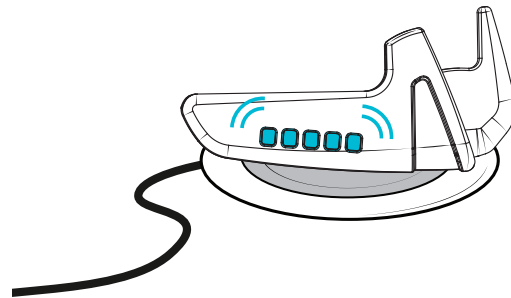

3

When all LEDs stop flashing the hand control is fully charged.

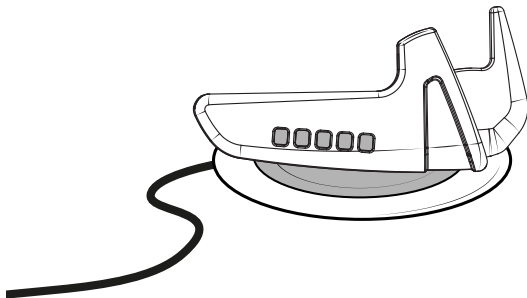

4

To test the battery level of the hand control, gently press the hand control lever until the LEDs start flashing. The number of LEDs flashing indicates the battery level of the remote.

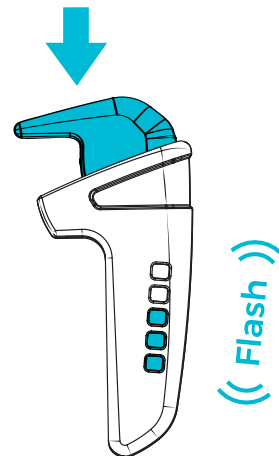

Board assembly – Power Pack

1



WARNING!

If you suspect that the battery connector has been in contact with water, or if the battery in any way looks damaged, do not connect the battery to the board! Please contact Radinn immediately for more information.

www.radinn.com/pages/contact-us



Note:

The jetboard Power Pack weighs almost 20 kilograms. We recommend that two persons lift the Power Pack in place.

Put the Power Pack in place according to the illustration.

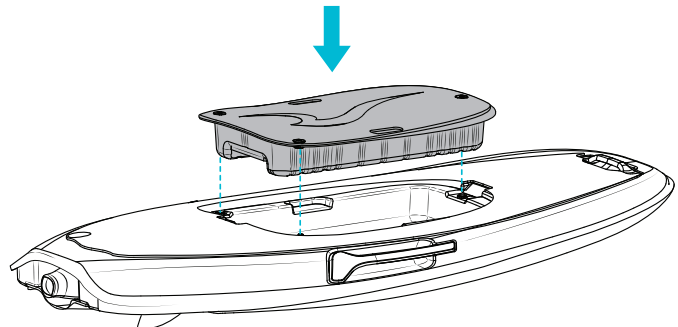

2

Locate the three spring-operated button holes.

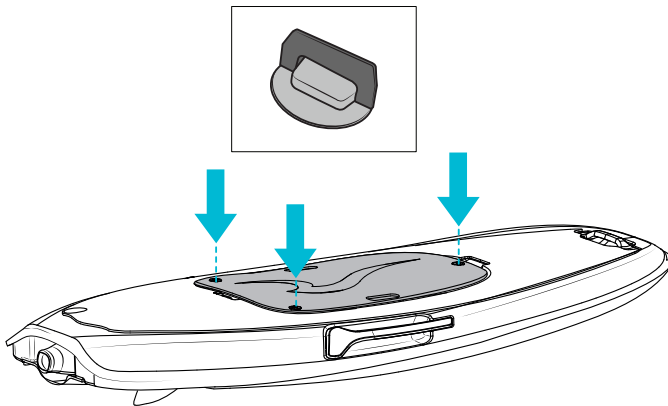

3

Push down the spring-operated button, and line up the spring screws with the thread, before screwing the lid shut. Make sure the screws are sealed tightly.

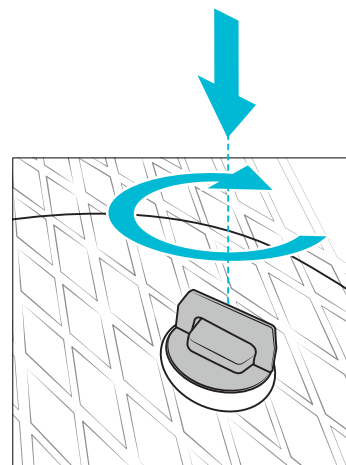

Board assembly – Power Pack

4

Flip the button lid edge in place.

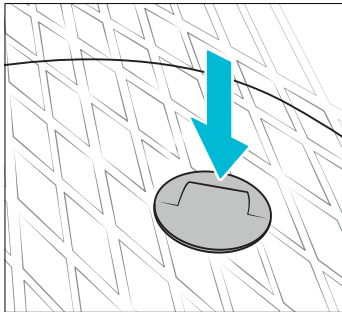

5

Make sure all button lids are fully closed!

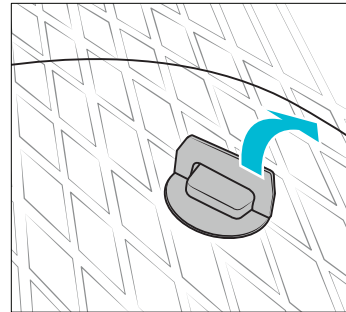

6

Pair the remote control with the board before launching the board into the water.

See the chapter **Pair the Remote Control with the jetboard.**



IMPORTANT:

To disengage the Power Pack, **make sure the board is dry**, and carefully unscrew the spring-operated buttons.

Pair board with Hand Control

1

Attach the magnetic key leash to the kill switch holder on the board.

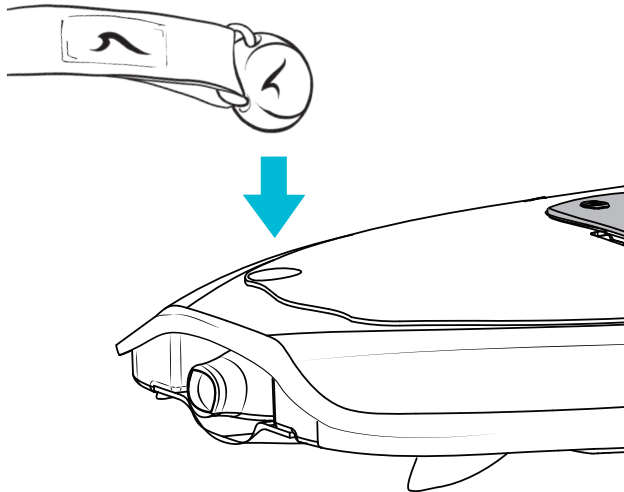

2

Press the throttle lever all the way down until the LEDs start flashing. Then let go of the lever.

The flashing LEDs indicate that the throttle is trying to connect to the board. (The number of LEDs flashing indicates the battery level of the remote.)

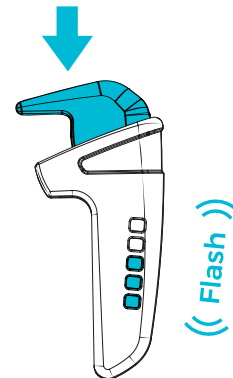

3

When the remote successfully pairs with the board, all five LEDs will flash once.

**Note:**

It will take between 15 to 60 seconds to complete the pairing. If the remote control does not find the board after 60 seconds, repeat step 2.

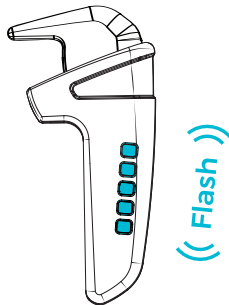

4

When the pairing is complete, the LEDs stop flashing and indicates the remaining battery of the Power Pack. Charge the Power Pack again if not all five LEDs light up.

Then gently push the lever to check if it's properly paired. If there is no response from the jet, please repeat from step 2.

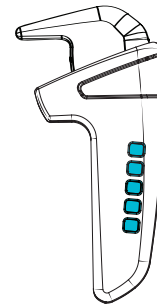

Remote Control Technical Specifications

Bluetooth	2.4 Ghz
Range	10 meter

Remote Control Indicator Table

Indication	Definition
Remote control vibrates briefly	Remote control and and board are paired and the magnetic key is attached
Remote control vibrates with a 20 sec interval	Board battery below 20%

Fasten and Secure Hand Control and Magnetic Key

1

Fasten and secure the magnetic key leash tightly around your ankle.

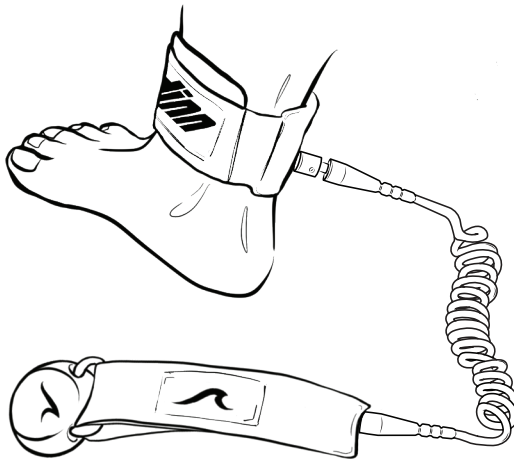

2

Fasten and secure the remote control strap around your wrist.



Note:

The remote control does not float, therefore it must be secured around your wrist.



Board assembly – Fins

1

Turn the board upside down to reveal the fin slots.

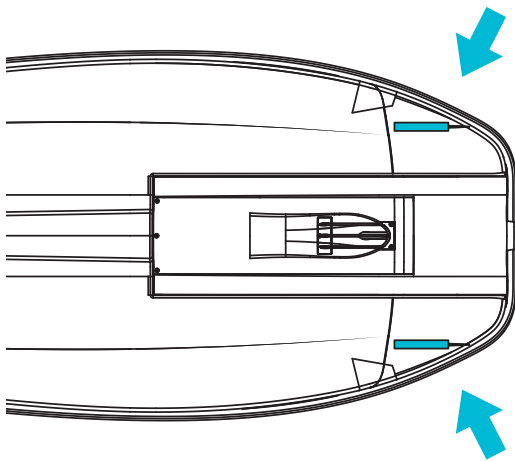

2

Attach the fins to the board according to the illustration.

To remove the fins, repeat this procedure in reversed order.



Note:

This is optional. The fins improve turning at lower speed.

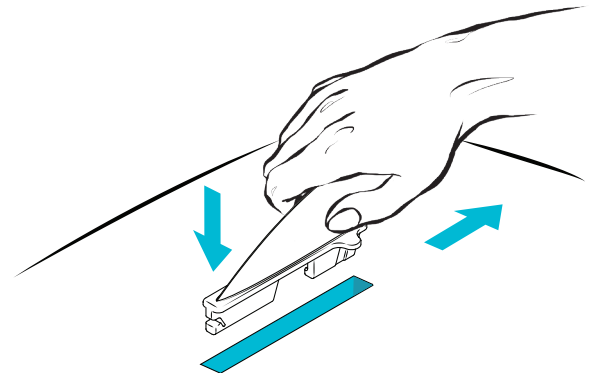

Launch the Radinn jetboard

1

Carefully lift the jetboard out of its bag or any other storage equipment.

Launch the jetboard in a calm area close to the water. Never attach the magnetic key while launching.



Note:

The jetboard weighs up to 45 kilograms. We recommend that launch of the jetboard is done by two persons.

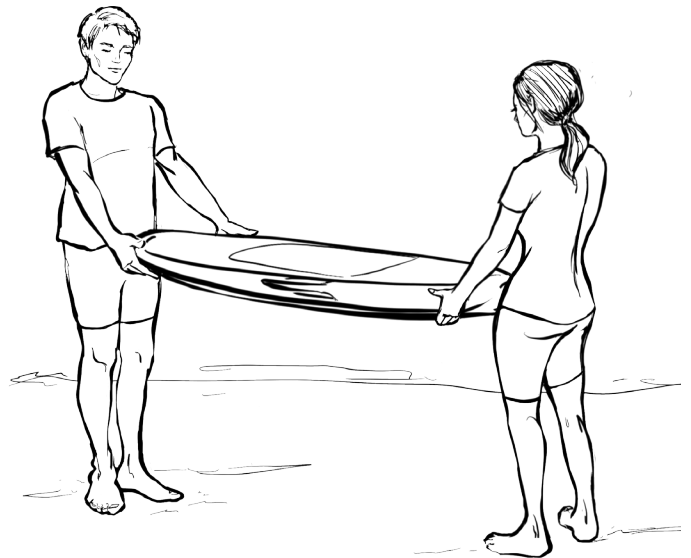

2

Before starting the jetboard, swim away from the shore a bit to avoid injuring other persons or damaging the board, boats or any other property. Make sure the depth below the board is at least 1,5 meters (5 feet).

**WARNING:**

The jetboard is a powerful personal watercraft. Be careful when starting the jet as the stream can reach up to 10 meters and potentially harm people and/or damage property.

Start sitting on knees

1

Before starting the jetboard, swim away from the shore a bit to avoid injuring other persons or damaging the board, boats or any other property.

Make sure the depth below the board is at least 1,5 meters (5 feet). Begin sitting on your knees and hold on to the front handle.

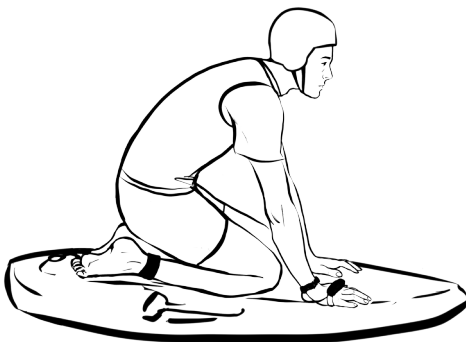

2

Attach the magnetic key to the magnetic key holder. Evenly press the throttle lever on the remote.

Avoid sudden release during acceleration. To keep the jetboard steady when increasing speed, maintain thrust while evenly pressing the throttle lever.

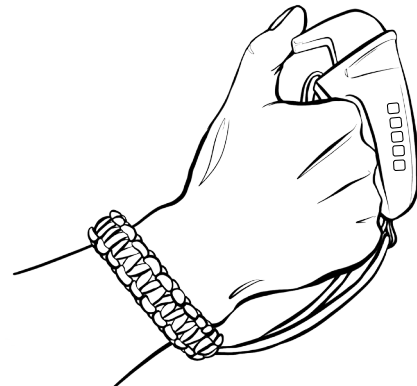

3

After a few seconds the board will be in a tail heavy position. Shift your body weight forward while pressing the nose of the board as close to the water surface as possible, without diving.

4

When the board begins accelerating, shift your body weight back again.

It is important to keep the torque unchanged or increasing during the entire planing process.

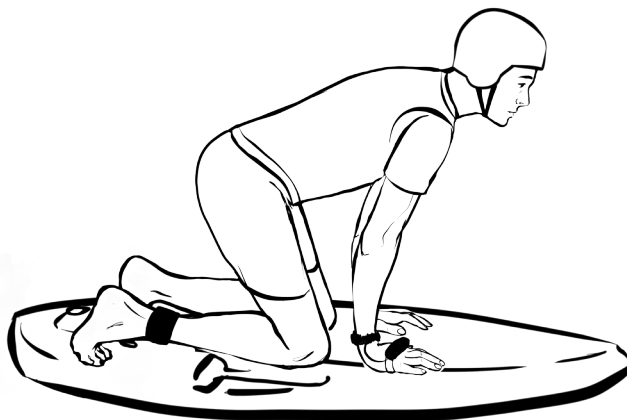

Standing up

1

When you have reached balance and speed, try standing up. Keep a constant torque through the whole procedure.



Tip!

Use one of the handles to support your balance. Begin with your front leg and slowly get up. Keep your knees bent and look straight ahead.

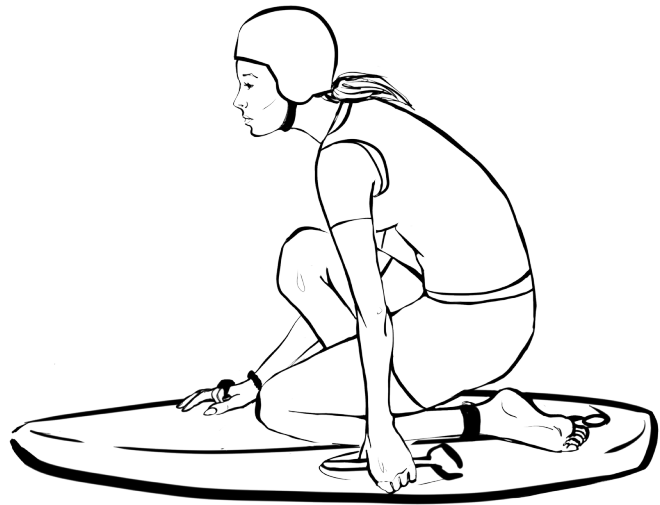

2

The better your stance, the lesser the air suction.

Shift your body weight backward and forward a little to find that perfect stance and balance.

**Tip!**

Make sure to have a comfortable stance and carefully listen to the sound of the jet.



Turning

1

Fins are available for the jetboard, as an optional accessory. See chapter **Install the jetboard Fins** (optional) for instructions on how to install them.

The fins improve turning at lower speed.

2

Keep up the speed and lean towards the direction you desire.

Shifting your weight towards the back of the board will help you when turning.

Turn left



Turn right



Common mistakes

1

A common mistake is to lean too far away from the nose of the board.

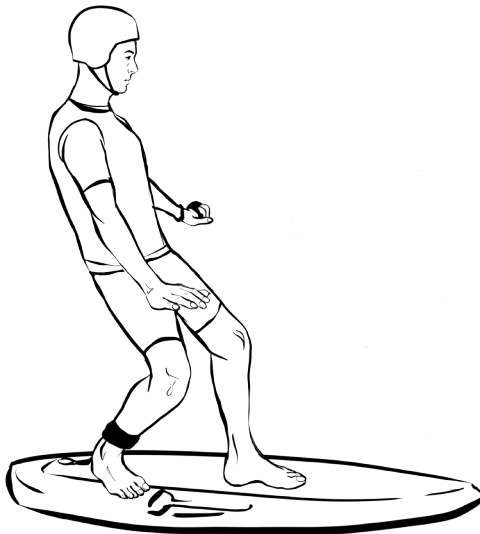

2

Another mistake is decreasing the thrust while leaning forward during start. This causes the board to dive.





Note:

The board brakes fast if there is no thrust. The motor shuts down automatically when the magnetic key is disconnected from the board. This guarantees that the board will stop if the surfer takes a dive.

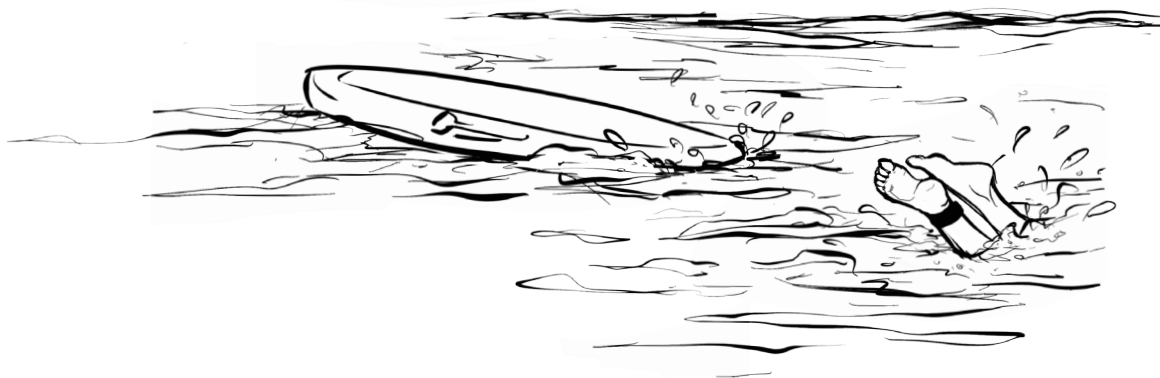

Radinn jetboard Maintenance

1

Fill a bottle with fresh water.

Connect the bottle to the jet outlet cooling connector (A).

Squeeze the bottle until the water has passed through the system.

2

Always repeat the procedure (1) after every surf in salt water. Corrosion and salt may clog the system and thereby decrease the water flow and getting the motor to overheat.

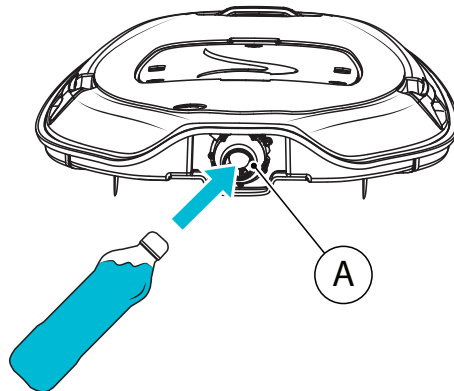

3

In the battery compartment, put the connector protection in place, and make sure it is tightly sealed around the battery connector.

Rinse the entire board with fresh water to ensure that all salt water is removed to prevent corrosion.

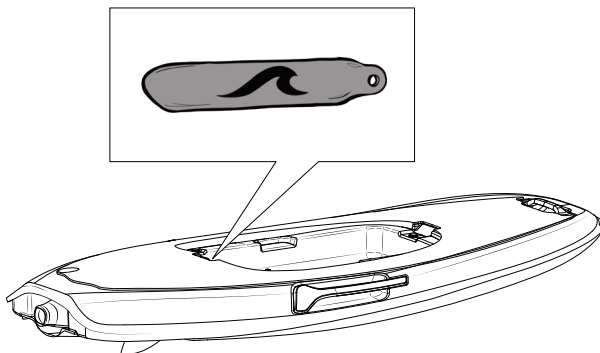

4

Dry the board prior to placing it in its bag or any other storage equipment.



Note:

Do not attach the connector protection for long term storage of the Radinn jetboard..



MAINTENANCE

5

Always store the jetboard in a dry location with room temperature (15–28 °C/59–82 °F).

6

Prior to running the jet outlet, always check for plastic and other garbage in it.

Turn the jetboard upside down on top of the board's bag and look into the jet intake.



Note:

Always disconnect both the battery and the magnetic key from the board if you need to remove plastic or any other foreign objects from the jet.



Radinn Power Pack Maintenance

1

Store the Power Pack in a room with dry air at room temperature (15–28 °C / 59–82 °F).

3

Fully charge the battery **before using it**.

2

Always charge the battery fully **before storing it**.

4

Charge your battery fully **regularly** (at least every other month).



Note:

Risk of permanent breakdown of the Power Pack if the voltage drops too much.

Charge and balance it at least every two months when not in use.

5

Never fully discharge the battery.



Note:

Regardless of if you have purchased the Radinn Speed Charger as an extra, We strongly urge you to use the standard jetboard Power Pack Charger once every ten charging cycles to maximize the battery's life cycle.

Power Pack Technical Specifications

Battery type	Li-Ion 50.4 V , high capacity cells
Battery maximum capacity	69 Ah 3 478 Wh
Battery weight	25 kg

Disposal of the Power Pack and all the other parts of the Radinn jetboard

When recycling the jetboard, the local recycling regulations must always be followed!



If you need to dispose the Power Pack, then do so according to the local laws and regulations of your region.

Some batteries may be recycled, and may be accepted for disposal at your local recycling center. If you are not able to identify the applicable rules in your area, please check with your local recycling center before disposal.



Visit us at radinn.com
or follow us on



@radinnoofficial

